



FM-Eco4light+S - MGS600
FM-Eco4light+
FM-Eco4light

NISSAN E-NV200

Updated: 190305 1252



Nissan E-nv200

... is an electrical vehicle, requiring special installation and configuration:

Vehicle is not able to start unless RFID card has been scanned first.

Installation

- Starterskill is inverted, using pin 87A.
- Beeper dismounted - if existing installation.
- LED turns on GREEN when card has been scanned.

Configuration

- Digital output is inverted.
- Driver registration timeout = 30 seconds

Firmware

- Version 3.27 or higher



Nissan E-nv200

Configuration Starterkill inverted output

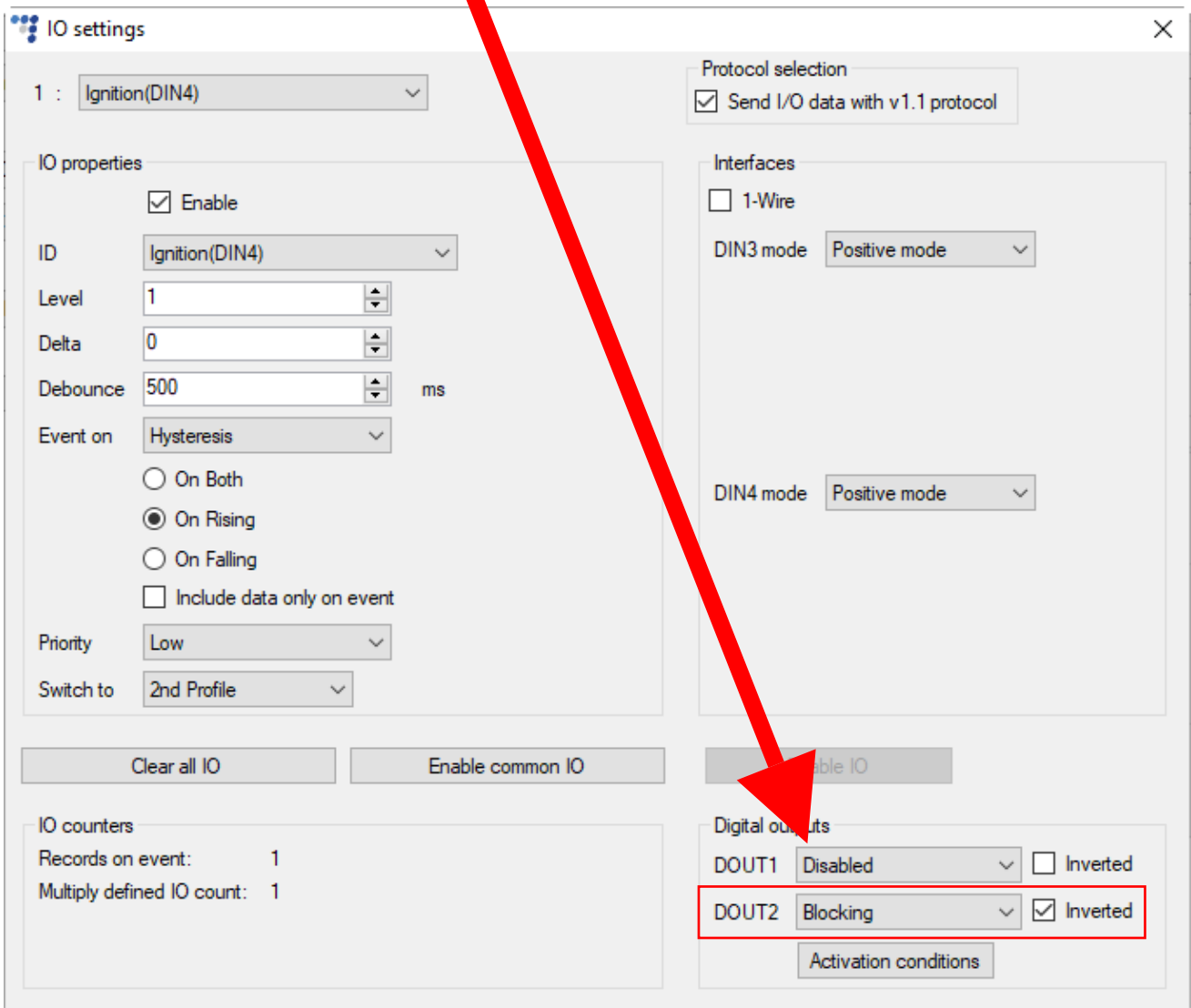

IO settings

1 : Ignition(DIN4)

Protocol selection

Send I/O data with v.1.1 protocol

IO properties

Enable

ID: Ignition(DIN4)

Level: 1

Delta: 0

Debounce: 500 ms

Event on: Hysteresis

On Both

On Rising

On Falling

Include data only on event

Priority: Low

Switch to: 2nd Profile

Interfaces

1-Wire

DIN3 mode: Positive mode

DIN4 mode: Positive mode

Clear all IO

Enable common IO

Enable IO

IO counters

Records on event: 1

Multiply defined IO count: 1

Digital outputs

DOUT1: Disabled Inverted

DOUT2: Blocking Inverted

Activation conditions



Nissan E-nv200

Configuration

Driver registration timeout = 30 seconds

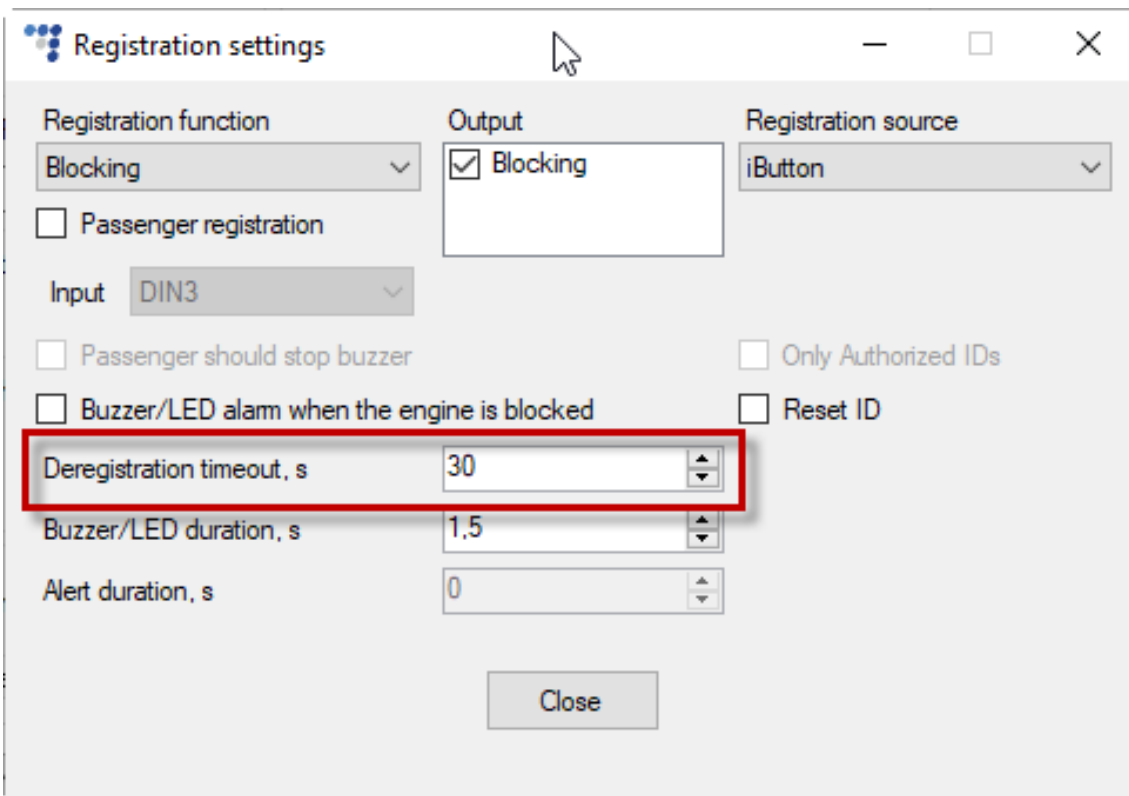

The image shows a software configuration window titled "Registration settings". The window contains several settings:

- Registration function:** A dropdown menu set to "Blocking".
- Output:** A checkbox labeled "Blocking" which is checked.
- Registration source:** A dropdown menu set to "iButton".
- Passenger registration:** An unchecked checkbox.
- Input:** A dropdown menu set to "DIN3".
- Passenger should stop buzzer:** An unchecked checkbox.
- Only Authorized IDs:** An unchecked checkbox.
- Buzzer/LED alarm when the engine is blocked:** An unchecked checkbox.
- Reset ID:** An unchecked checkbox.
- Deregistration timeout, s:** A numeric input field with a value of 30, highlighted with a red box.
- Buzzer/LED duration, s:** A numeric input field with a value of 1.5.
- Alert duration, s:** A numeric input field with a value of 0.

At the bottom of the window is a "Close" button.



Nissan E-nv200

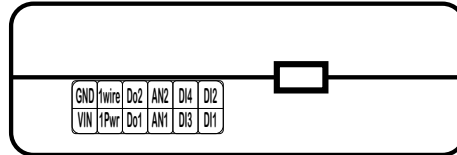

Special configuration with inversed DIGOUT2 (Blocking)
Firmware 3.27 or higher.

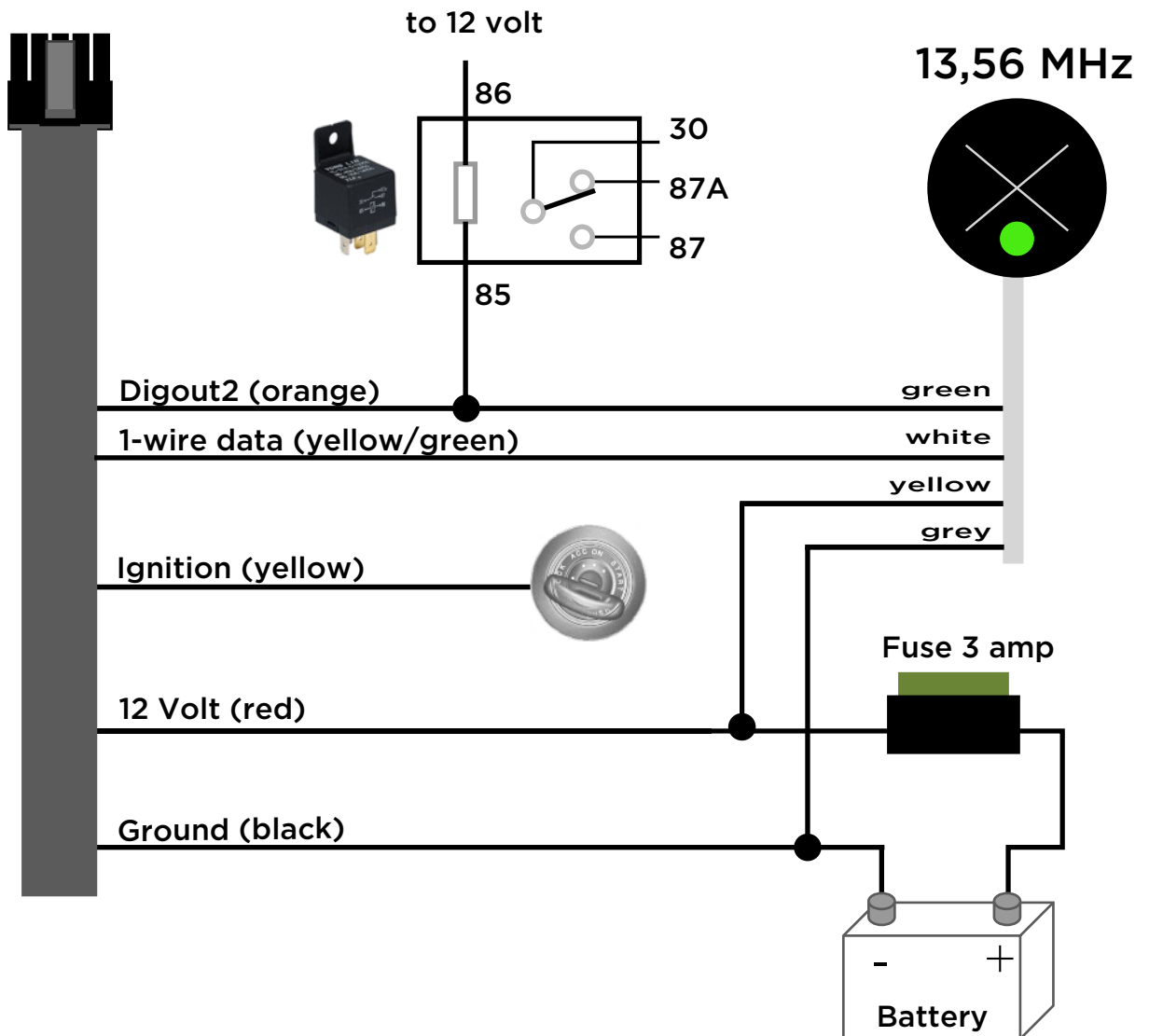



Nissan E-nv200

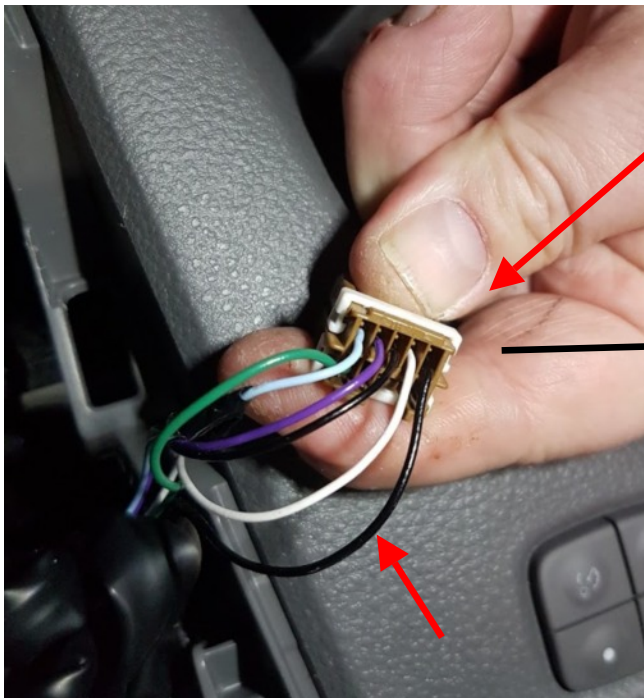

Connector
from the
startbutton

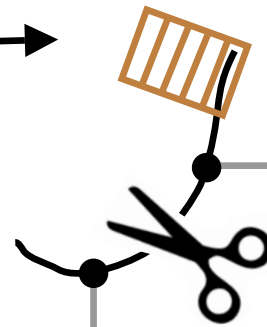

to relay pin 30

to relay pin 87